

VACUUM REGULATOR

760mmHg CONTINUOUS HIGH VAC



PM3600



PM3600D

High vacuum, modular design, compact vacuum regulator!

It's Field Serviceable...

The unique modular design makes repair a breeze for any biomed or central supply department. The unit is made up of six (6) easy-to-replace modular components.

It's Durable...

Unlike the normal plastic inlet and outlet connections on most units, the cast metal backplate connections are extremely durable, thereby saving unnecessary repair costs.

It's Compact...

As a result of its modular design, the unit is 25-50% smaller than other suction regulators making it the product of choice for crowded wall and rail areas.

It's Powerful...

With 0-760 mmHg the High Vac can give you more suction & flow with visible readings.

It's Sturdy...

The case is made of strong ABS plastic. It features a smooth surface with rounded corners making cleaning easy. The case also houses the gauge for extra protection.

It's User-Friendly...

The large control knob and easy-to-read settings make vacuum adjustments simple, even in emergency situations.



MODULAR CONSTRUCTION

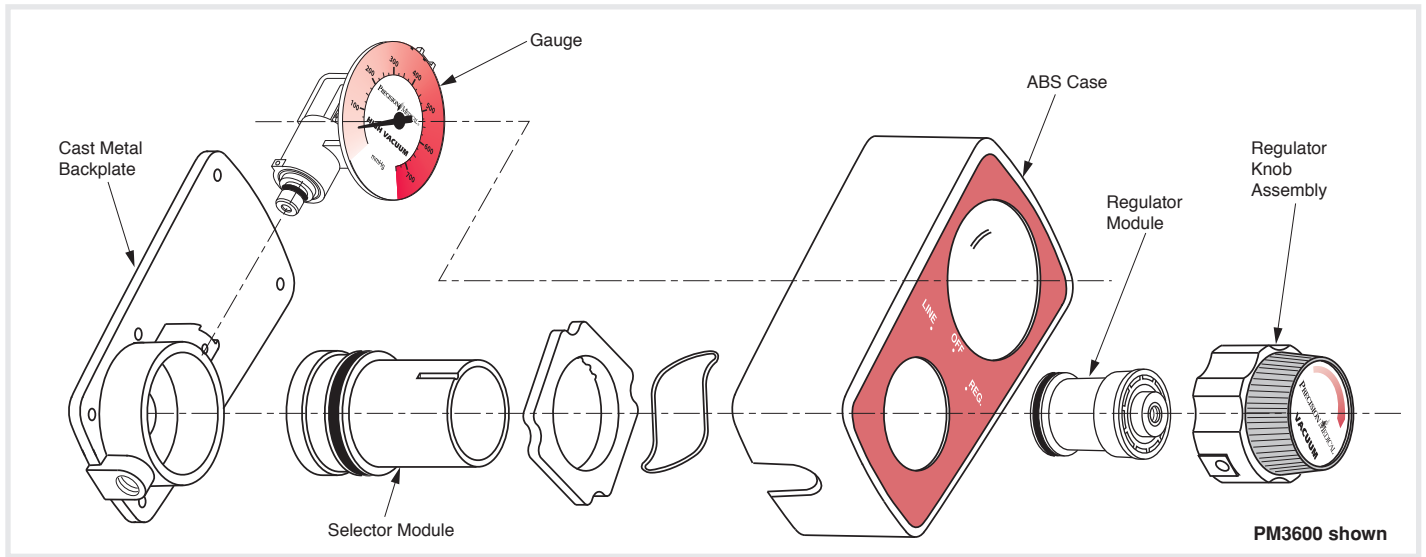

SPECIFICATIONS

Gauge Reading: 0-760 mmHg
Vacuum Operating Range: 0-760 mmHg
Modes: PM3600 LINE - OFF - REG. (Regulated) PM3600D LINE - OFF - REG. (Regulated)

ORDERING INFORMATION

		VACUUM SOURCE CONNECTION (on back of unit)										
		1/8" N.P.T.F	DISS HEX	DISS H.T.	OHMEDA	CHEMETRON	OXEQIP (Old Style)	OXEQIP (Medstar)	PURITAN-BENNETT	SCHRADER	TUBING NIPPLE	90 TUBING FITTING
BOTTOM CONNECTION (inlet)	TUBING NIPPLE	PM3601 PM3601D	PM3602 PM3602D	PM3603 PM3603D	PM3604 PM3604D	PM3605 PM3605D	PM3606 PM3606D	PM3607 PM3607D	PM3608 PM3608D	PM3609 PM3609D	PM3610 PM3610D	PM3611 PM3611D
	DISS MALE	PM3612 PM3612D	PM3613 PM3613D	PM3614 PM3614D	PM3615 PM3615D	PM3616 PM3616D	PM3617 PM3617D	PM3618 PM3618D	PM3619 PM3619D	PM3620 PM3620D	PM3621 PM3621D	PM3622 PM3622D
	OHMEDA STYLE TRAP BOTTLE CONNECTION	PM3623 PM3623D	PM3624 PM3624D	PM3625 PM3625D	PM3626 PM3626D	PM3627 PM3627D	PM3628 PM3628D	PM3629 PM3629D	PM3630 PM3630D	PM3631 PM3631D	PM3632 PM3632D	PM3633 PM3633D
	45 TRAP BOTTLE CONNECTION	PM3634 PM3634D	PM3635 PM3635D	PM3636 PM3636D	PM3637 PM3637D	PM3638 PM3638D	PM3639 PM3639D	PM3640 PM3640D	PM3641 PM3641D	PM3642 PM3642D	PM3643 PM3643D	PM3644 PM3644D



ISO 13485
Certified

Precision Medical, Inc.
300 Held Drive • Northampton, PA 18067
Phone: 610-262-6090 Toll-Free Phone: 1-800-272-7285
Fax: 610-262-6080 Toll-Free Fax: 1-800-352-1240
Visit us on the Web: www.precisionmedical.com